

INITIAL RECEIPT

United States Department of the Interior
Bureau of Land Management
 DIV OF LANDS, MINRLS & ENERGY
 ONE N CENTRAL AVE
 PHOENIX, AZ 85004 -4427
 Phone: 602-417-9200

Receipt	
No:	4717366

Transaction #: 4842426
Date of Transaction: 03/18/2020
CUSTOMER:
STEVEN E NEEDHAM 2031 E PARADISE LN PHOENIX, AZ 85022-3439 US

LINE #	QTY	DESCRIPTION	REMARKS	UNIT PRICE	TOTAL
1	1.00	LOCATABLE MINERALS / MINING CLAIMS-NEW, UNADJUD, ONE OR MORE AUTH NOS / NEW MINING CLAIM PROCESSING FEE CASES: AMC459597/\$20.00		- n/a -	20.00
2	1.00	LOCATABLE MINERALS / MINING CLAIMS-NEW, UNADJUD, ONE OR MORE AUTH NOS / NEW MINING CLAIMS LOCATION FEE CASES: AMC459597/\$40.00		- n/a -	40.00
3	1.00	LOCATABLE MINERALS / MINING CLAIMS-NEW, UNADJUD, ONE OR MORE AUTH NOS / NEW MINING CLAIMS MAINTENANCE FEE CASES: AMC459597/\$165.00		- n/a -	165.00
TOTAL:					\$225.00

PAYMENT INFORMATION				
NOTE: Items will appear on credit card statement as "Bureau of Land Mgmt CO".				
1	AMOUNT:	225.00	POSTMARKED:	N/A
	TYPE:	CREDIT CARD	RECEIVED:	03/18/2020
	NAME:	NEEDHAM, STEVEN E 2031 E PARADISE LN PHOENIX AZ 85022-3439 US		
	CARD NO:	XXXXXXXXXXXX2337	AUTH CODE:	08434C
	NAME ON CARD:	STEVEN E NEEDHAM		
	SIGNATURE:			

SCANNED 5/18/2020
 BY: Rama

ENTERED
 APR 01 2020

REMARKS

This receipt was generated by the automated BLM Collections and Billing System and is a paper representation of a portion of the official electronic record contained therein.

APR 01 2020

CORRESPONDENCE

TRANSFERS

MAINTENANCE FEES

WAIVERS

POL/NOI

MISCELLANEOUS

**LOCATION NOTICES
AMENDMENTS
STATUS SHEET
GEO REPORT/MTP**

MINING CLAIM STATUS REPORT

Data Entered: 4/1/2020

MTP Checked By: 4/1/2020
GEO Checked By: 4/1/2020

LEAD SERIAL NUMBER: AMC 459597 thru AMC _____

NUMBER OF CLAIMS & TYPE:

1 LODE

PLACER

ASSOCIATION PLACER

MILL SITE

TUNNEL SITE

CHARGES:

Processing Fee @ \$20 = \$ 20
Location Fee @ \$40 = \$ 40
Maintenance Fee @ \$165 = \$ 165
Add'l Maint Fee for Assoc Placer = \$ _____
SUBTOTAL \$ _____
Other Fees \$ _____
Other Fees \$ _____
TOTAL \$ 225

TOTAL ACREAGE: _____ Per Claim
(Placer Only)

NUMBER OF LOCATORS: _____

DOCUMENTS RECEIVED VIA: Over-the-Counter [] Mail [] **TIMELY FILED:** Yes [] No []

LEGAL DESCRIPTION: T 7N R 1W SEC 12
T _____ R _____ SEC _____
T _____ R _____ SEC _____
T _____ R _____ SEC _____
T _____ R _____ SEC _____

BLM [] FOREST SERVICE [] _____ SUBJ TO PL 359: Yes [] No []
WILDERNESS AREA [] _____

SPLIT ESTATE: N/A [] SX [] PX [] OTHER [] _____
SRHA [] Was proper Notice filed if located on SHRA Land? Yes [] No []

RECONVEYED MINERALS ON BLM LAND REQUIRE OPENING ORDER FROM 1944 TO 1993:
Open to Entry On _____ N/A []

COMMENTS/STATUS: VOID [] PARTIALLY VOID [] PVT MINERALS [] WITHDRAWN LANDS []
OTHER [] _____

[] Claimant acknowledges that portions of the following claim(s) site(s) may be void or voidable.

Printed Name of Claimant _____ Signature of Claimant _____

*****FINAL ADJUDICATION*****
DATE _____ INITIALS _____

AMC459597

RECEIVED
BLM AZ STATE OFFICE

2020 MAR 18 P 2:01

PHOENIX, ARIZONA

LOCATION NOTICE FOR PLACER MINING CLAIM

Amendment BLM Serial # _____

NOTICE IS HEREBY GIVEN that the Saguaro Tango
_____ placer mining claim has been located by
Steven E. Needham whose current mailing
address is 2031 E. Paradise Lane,
Phoenix, Arizona 85022-3439

RECEIVED
BLM AZ STATE OFFICE
2020 MAR 18 P 2:01
PHOENIX, ARIZONA
BLM
Date
Stamp

The general course of this claim is rectangular and it is situated in Yavapai
County, Arizona. This claim is 1320 feet in length and 660 feet in width.

20 Total Claim Acreage. This claim runs from the location monument on which this location notice is
posted at the SW corner of the claim approximately 1320 feet in a Northerly direction to the
North end line and 660 feet in a Easterly direction to the East end line. This claim is
marked by four monuments, one at each corner of the claim.

The location monument on which this notice is posted is situated within Section 012, Township
007 N, Range 001 W, Gila Salt River Base and Meridian, Arizona. This claim encompasses
portions of the following legal subdivision(s) if located by legal subdivision or the following quarter section(s),
section(s), Township(s) and Range(s) E 1/2 NW 1/4 SE 1/4, Sec. 12, T. 7N,
R. 1W., Gila Salt River Base and Meridian, Arizona.

The locality of this claim with reference to some natural object or permanent monument and additional information
(if any) concerning its locality are as follows: _____

_____ The above information is shown on the attached map.

DATED AND POSTED on the ground this 26TH day of December, 2019.

LOCATOR(s) AGENT

Print Name(s) Steven E. Needham

Signature(s) [Signature]

Form MCF102
Revised Oct 2018

AMC459597

MINING CLAIM MAP

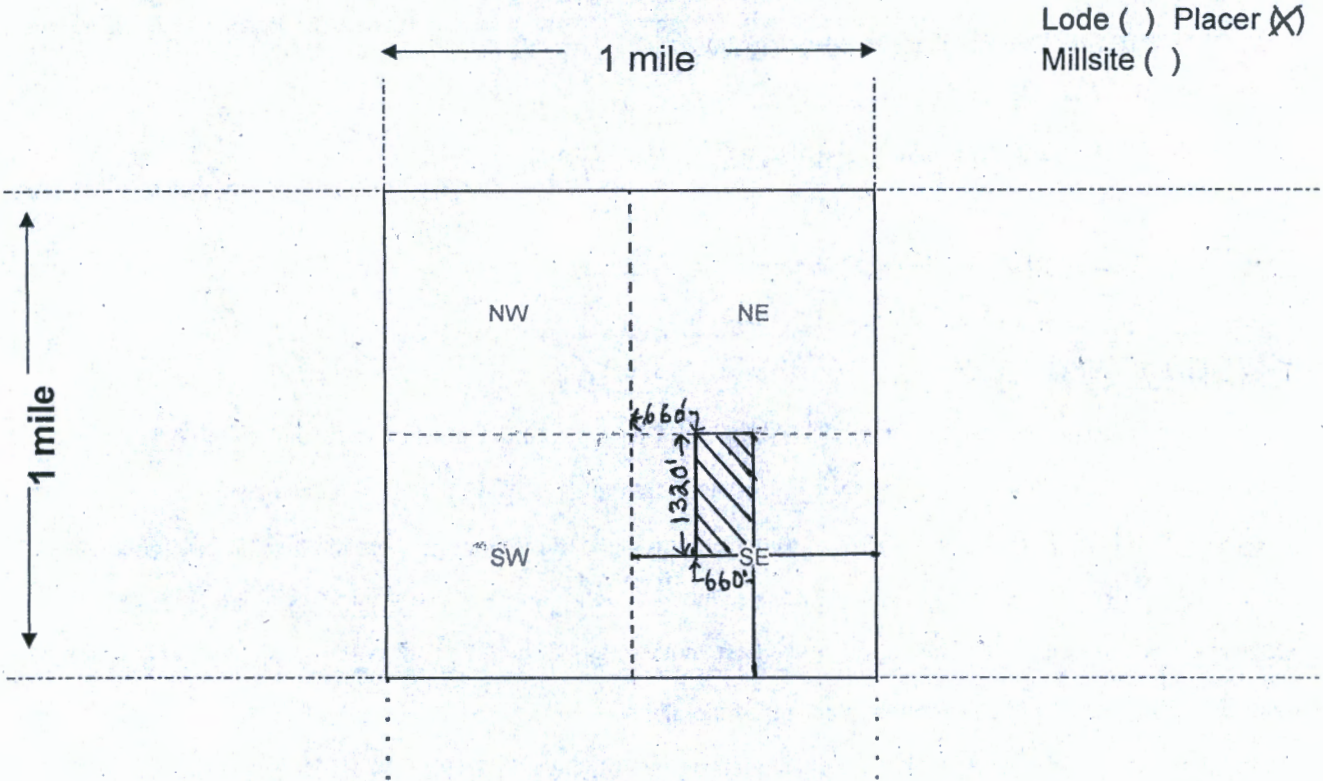

Scale: 1" = 2000 feet

1. The above map depicts the Saguaro Tango mining claim, which is located in Section (s) 012, Township 007 N, Range 001 W, Gila and Salt River Base and Meridian, Yavapai County, Arizona. Total claim acreage is 20 acres
2. The type of corner and location monuments used are as follows: 4 feet high, 1 1/2" x 1 1/2" solid wood, base of stone corner monuments, and location monument.
3. The bearings and distances in degrees and feet between claim corners and to a public land survey monument are as depicted on the map.
4. If the claim is a placer or millsite claim with exterior limits conforming to legal subdivisions of the public survey, provide a legal description of the claim The N.W. corner of the claim is 660' due East of the center of Section 12, T. 7N, R. 1 W. GSRM. Location Monument at S.W. corner of the claim.

Form MCF100a
Revised Oct 2018

Date and Time Run:
3/18/2020 2:53:43 PM

Page 1 of 1

DEPARTMENT OF THE INTERIOR
BUREAU OF LAND MANAGEMENT
Case Recordation

Geographic Report with Land

Case Suppression Flag is equal to / is in N
and Meridian Township Range Section is equal to 14 0070N 0010W 012
and Admin State is equal to AZ

NO WARRANTY IS MADE BY BLM
FOR USE OF THE DATA FOR
PURPOSES NOT INTENDED BY BLM

DEPARTMENT OF THE INTERIOR
BUREAU OF LAND MANAGEMENT
Case Recordation
Geographic Report with Land

Admin State: AZ
Geo State: AZ
Serial Number: AZA 015018

Total Case Acres: 6,401.770

Case type	Case Disp	Mer	Twp	Rng	Sec	Sur Type	Sur Nr	Suf	Subdivision	Pending Action
311111	CLOSED	14	0070N	0010W	012	ALIQ			ALL;	

Admin State: AZ
Geo State: AZ
Serial Number: AZA 019334

Total Case Acres: 33.000

Case type	Case Disp	Mer	Twp	Rng	Sec	Sur Type	Sur Nr	Suf	Subdivision	Pending Action
282201	AUTHORIZED	14	0070N	0010W	012	ALIQ			E2;	

Admin State: AZ
Geo State: AZ
Serial Number: AZA 030330

Total Case Acres: 1.000

Case type	Case Disp	Mer	Twp	Rng	Sec	Sur Type	Sur Nr	Suf	Subdivision	Pending Action
293200	EXPIRED	14	0070N	0010W	012	ALIQ			E2;	

Admin State: AZ
Geo State: AZ
Serial Number: AZA 030598

Total Case Acres: 1.000

Case type	Case Disp	Mer	Twp	Rng	Sec	Sur Type	Sur Nr	Suf	Subdivision	Pending Action
293200	EXPIRED	14	0070N	0010W	012	FF		1	PORTION OF;	

Admin State: AZ
Geo State: AZ
Serial Number: AZA 030745

Total Case Acres: 1.000

Case type	Case Disp	Mer	Twp	Rng	Sec	Sur Type	Sur Nr	Suf	Subdivision	Pending Action
293200	EXPIRED	14	0070N	0010W	012	ALIQ			ALL;	

Admin State: AZ
Geo State: AZ
Serial Number: AZA 031481

Total Case Acres: 1.000

Case type	Case Disp	Mer	Twp	Rng	Sec	Sur Type	Sur Nr	Suf	Subdivision	Pending Action
293200	CLOSED	14	0070N	0010W	012	FF			PORTION OF;	

Admin State: AZ
Geo State: AZ
Serial Number: AZA 031569

DEPARTMENT OF THE INTERIOR
BUREAU OF LAND MANAGEMENT
Case Recordation

Total Case Acres: 1.000

Casetype	Case Disp	Mer	Twp	Rng	Sec	Sur Type	Sur Nr	Suf	Subdivision	Pending Action
293200	CLOSED	14	0070N	0010W	012	FF			PORTION OF;	

Admin State: AZ
Geo State: AZ
Serial Number: AZA 031769

Total Case Acres: 1.000

Casetype	Case Disp	Mer	Twp	Rng	Sec	Sur Type	Sur Nr	Suf	Subdivision	Pending Action
293200	CLOSED	14	0070N	0010W	012	FF			PORTION OF;	

Admin State: AZ
Geo State: AZ
Serial Number: AZA 031778

Total Case Acres: 1.000

Casetype	Case Disp	Mer	Twp	Rng	Sec	Sur Type	Sur Nr	Suf	Subdivision	Pending Action
293200	EXPIRED	14	0070N	0010W	012	FF			PORTION OF;	

Admin State: AZ
Geo State: AZ
Serial Number: AZA 031963

Total Case Acres: 1.000

Casetype	Case Disp	Mer	Twp	Rng	Sec	Sur Type	Sur Nr	Suf	Subdivision	Pending Action
293200	CLOSED	14	0070N	0010W	012	FF			PORTION OF;	

Admin State: AZ
Geo State: AZ
Serial Number: AZA 032307

Total Case Acres: 1.000

Casetype	Case Disp	Mer	Twp	Rng	Sec	Sur Type	Sur Nr	Suf	Subdivision	Pending Action
293200	CLOSED	14	0070N	0010W	012	ALIQ			E2;	

Admin State: AZ
Geo State: AZ
Serial Number: AZA 032518

Total Case Acres: 1.000

Casetype	Case Disp	Mer	Twp	Rng	Sec	Sur Type	Sur Nr	Suf	Subdivision	Pending Action
293200	CLOSED	14	0070N	0010W	012	FF			PORTION OF;	

Admin State: AZ
Geo State: AZ
Serial Number: AZA 032703

Total Case Acres: 2.450

Casetype	Case Disp	Mer	Twp	Rng	Sec	Sur Type	Sur Nr	Suf	Subdivision	Pending Action
281001	AUTHORIZED	14	0070N	0010W	012	ALIQ			N2;	Y

DEPARTMENT OF THE INTERIOR
BUREAU OF LAND MANAGEMENT
Case Recordation

Admin State: AZ
Geo State: AZ
Serial Number: AZA 033147

Total Case Acres: 1.000

Casetype	Case Disp	Mer	Twp	Rng	Sec	Sur Type	Sur Nr	Suf	Subdivision	Pending Action
292009	CLOSED	14	0070N	0010W	012	ALIQ			ALL;	

Admin State: AZ
Geo State: AZ
Serial Number: AZA 034458

Total Case Acres: 1.000

Casetype	Case Disp	Mer	Twp	Rng	Sec	Sur Type	Sur Nr	Suf	Subdivision	Pending Action
293200	PENDING	14	0070N	0010W	012	FF			PORTION OF;	

